

3. Installation

3.5 Lateral flashings installation

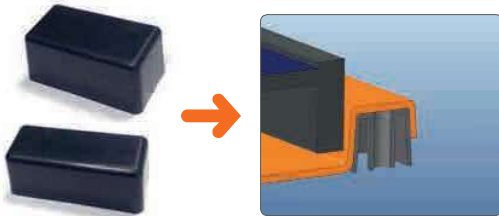

ATTENTION:
BEFORE INSTALLING THE LATERAL FLASHINGS, MAKE SURE TO PLACE THE WEDGES AT THE ARRAY ENDS, UNDER THE CORRUGATIONS, WHERE THE END CLAMPS ARE LOCATED.

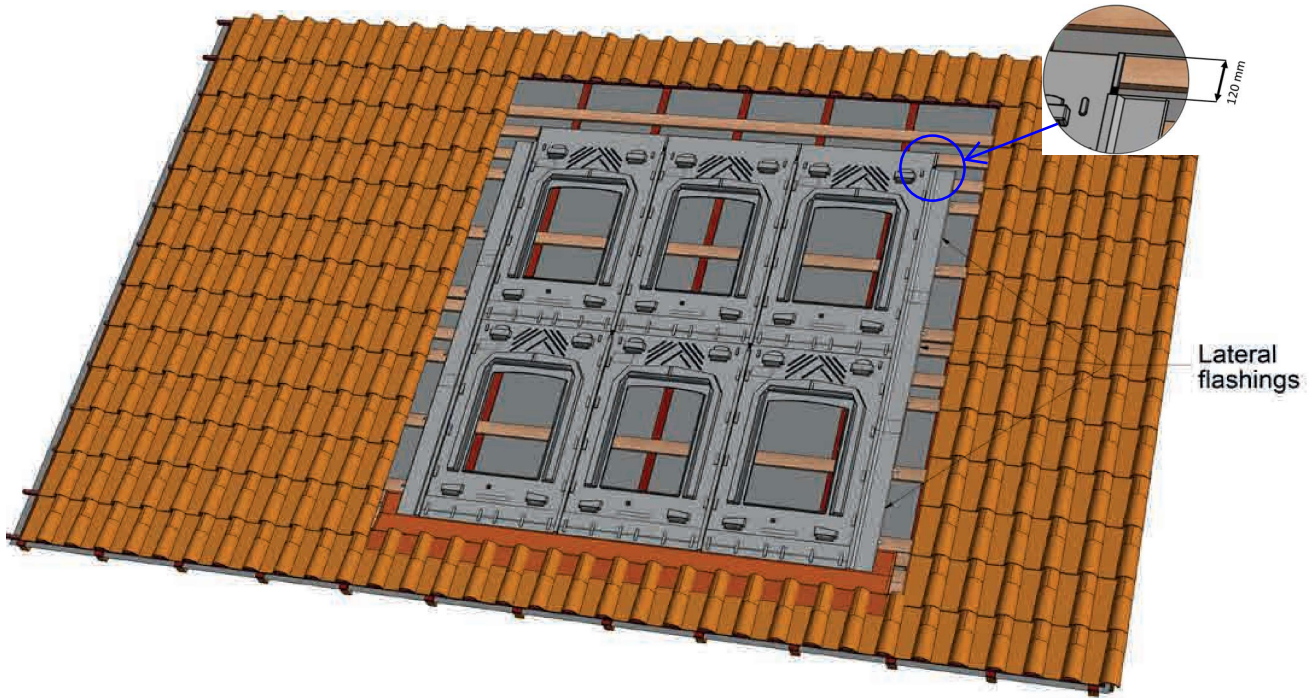
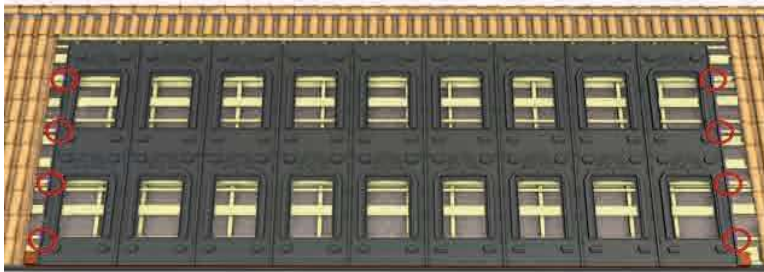

TIP:
Mark their position on the inner surface of the panel to identify them after positioning the lateral flashings.

- Place the lateral flashings of the low end of the first row of panels, up to 120 mm of the upper edge of the last row. The overlap between two parts of the lateral flashing will be at least 150 mm. Each will be held in place by at least 2 attachment hooks.

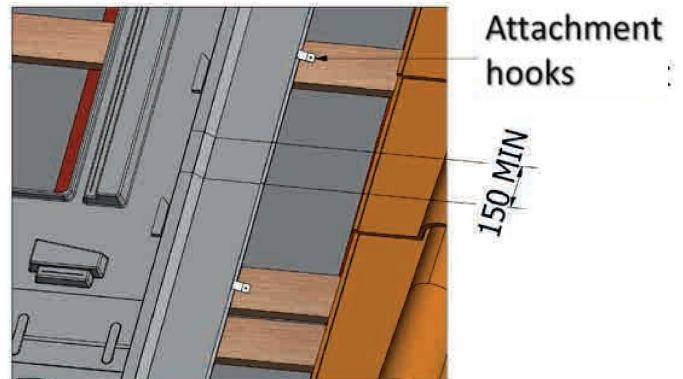

3. Installation

- Carry out the pre-drilling using a 10 mm wooden drill bit on the 4 remaining attachment points of the GSE frame.

Tip: It is possible to pre-drill the expanding points of the frame before mounting on the roof. The frames are drilled individually (do not drill several frames at the same time).

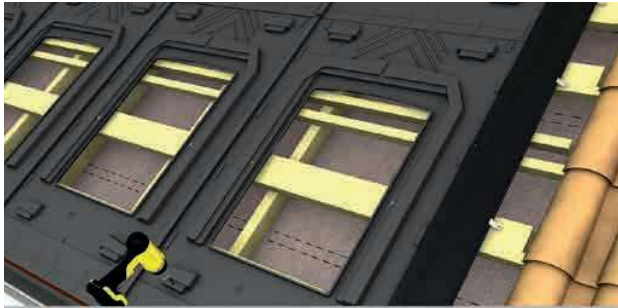

Pre-drilling of frames: 4 attachment points

- Screw the 4 attachment points of the frame.

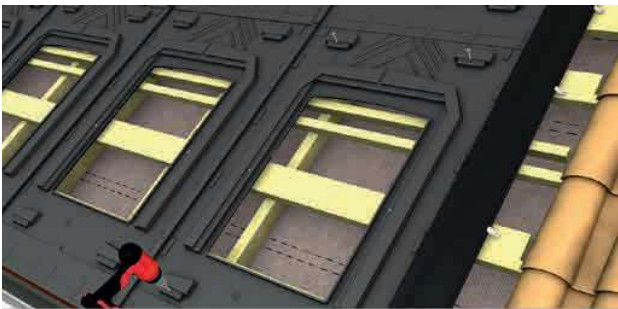

Screwing of GSE frames

- Then, pre-drill the fixing points of the clamps.



- For end clamps, pre-drill through the flashing, the frame's corrugation and the wedges.



Pre-drilling of GSE frames + flashings + edge wedges

Reminder:
It is prohibited to drill in the outflow zones and at the high points of the GSE frame. It may compromise the integrity of the photovoltaic system and its watertightness.
Please refer to the plans page 6 & 7 for the location of the fixing points.

